

FOR LEASE OFFICE / WAREHOUSE

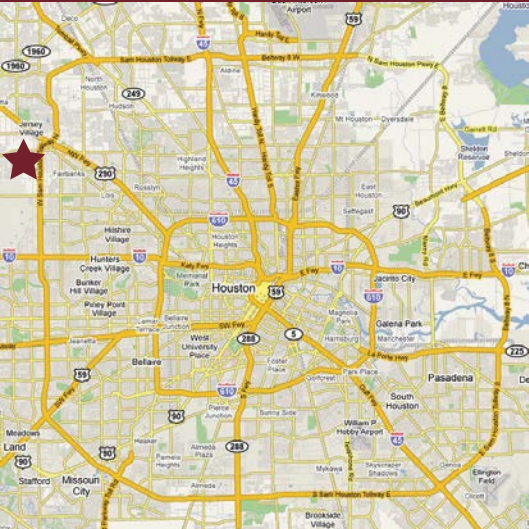

For further information
please contact:

Copeland Rhea / Charlie Christ
P 713.789.2529
F 713.782.3755
crhea@claydevelopment.com

FEATURES

- 15,000 sf building including 5,085 sf offices and 9,915 sf warehouse
- Located at Cunningham Business Park, off of Cunningham Road just South of W Little York in NW Harris County.
- Excellent Access to Beltway 8, I-10 and Hwy 290
- 10 ton crane ready, 24 ft. eave height



6431 CUNNINGHAM ROAD CUNNINGHAM BUSINESS PARK



FOR LEASE OFFICE / WAREHOUSE

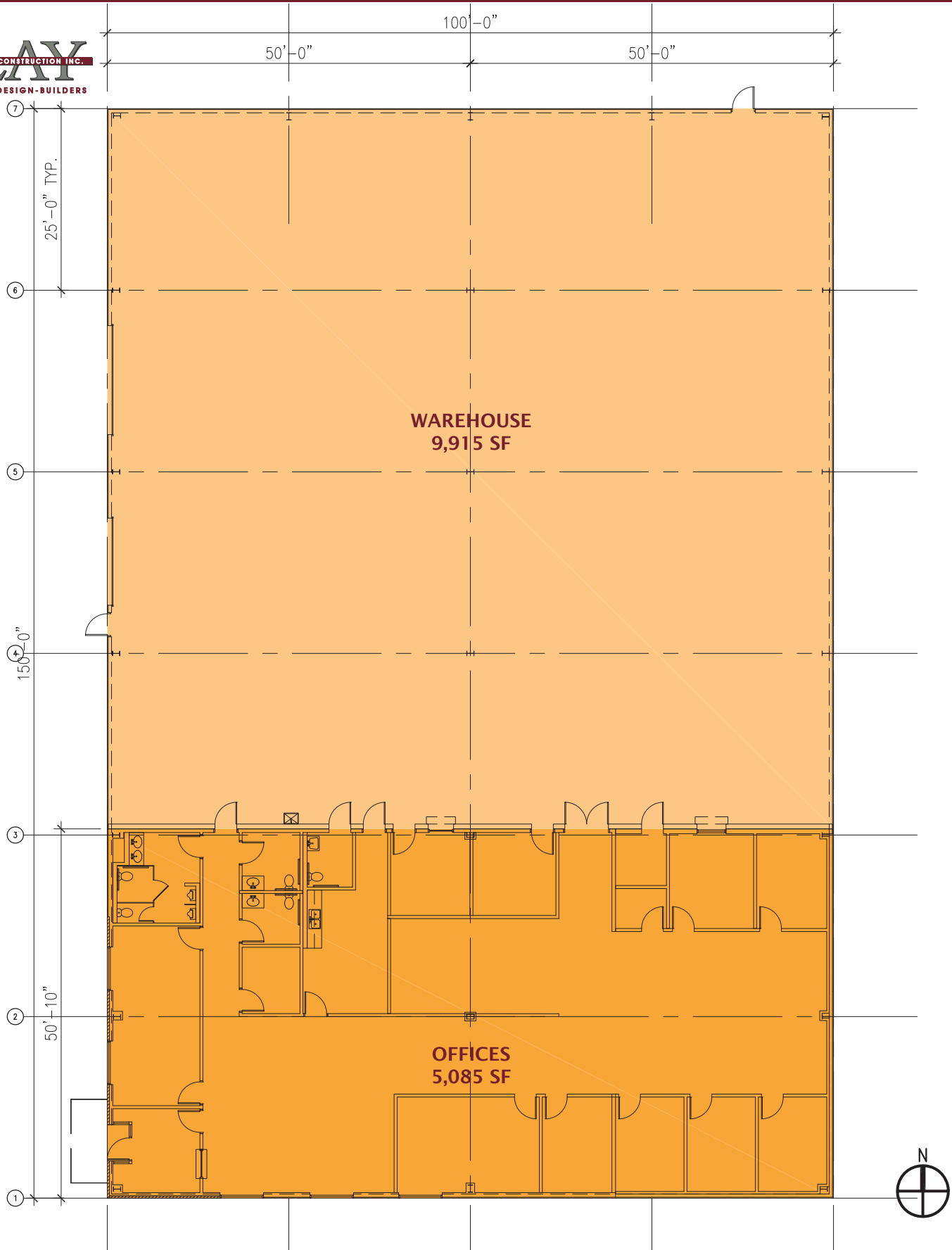

**6431 CUNNINGHAM ROAD
CUNNINGHAM BUSINESS PARK**